

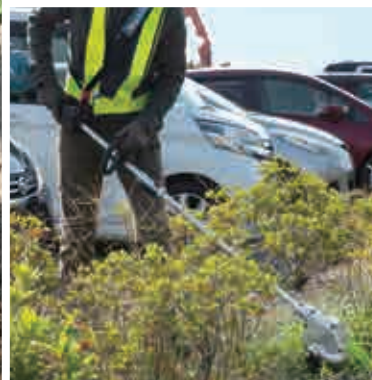

Weeding Attachment WA400MP

For weeding, soil aeration, or hoeing



Compatible models: UX01G, DUX60, DUX18

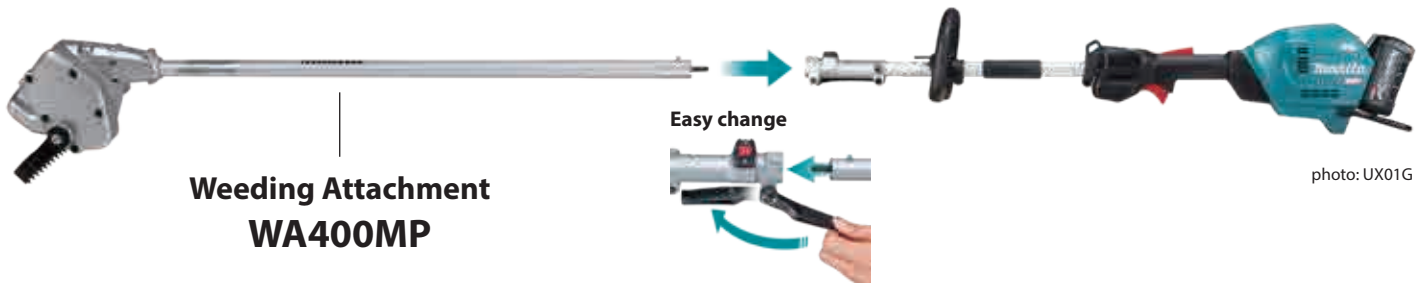

Weeding Attachment
WA400MP

Easy change

photo: UX01G

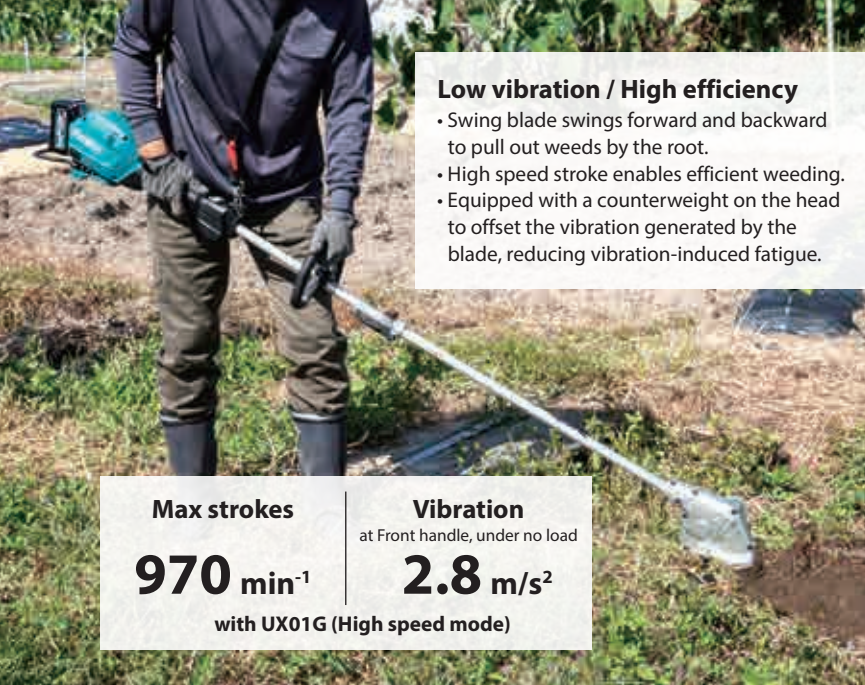

Low vibration / High efficiency

- Swing blade swings forward and backward to pull out weeds by the root.
- High speed stroke enables efficient weeding.
- Equipped with a counterweight on the head to offset the vibration generated by the blade, reducing vibration-induced fatigue.

Max strokes

970 min⁻¹

with UX01G (High speed mode)

Vibration

at Front handle, under no load

2.8 m/s²

Adjustable blade installation angle

Effective weeding on both flat grounds and slopes with the following three blade installation angle settings:

- 0°: For weeding on flat grounds
- 25° forward/backward: For weeding on slopes such as furrows, banks and more

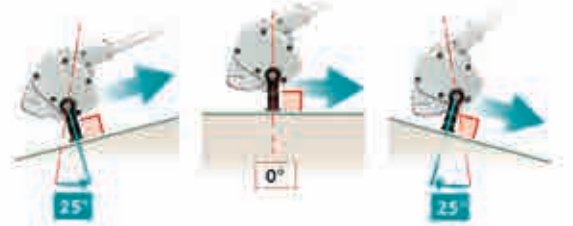

User-replaceable blade

- User can replace the blade by removing two screws when it becomes worn down.
- Three different blades are available depending on applications. Refer to the table below for details.



Use the blade edge for hard soils
Thoroughly removes stubborn weeds by loosening soils

Weeding blade 220 set

Standard equipment

Part No. 1913L5-4*

Weeding operation in large areas
Working width: 220 mm
Working depth: 35 mm



Weeding blade 80 set

Optional accessory

Part No. 1913L6-2*

Weeding operation in tight areas
Working width: 80 mm
Working depth: 50 mm



Cultivator blade 170 set

Optional accessory

Part No. 1913L7-0 *

Weeding operation while deeply digging into the soil
Working width: 170 mm
Working depth: 50 mm



*with Blade cover assembly

Weeding Attachment WA400MP

Standard equipment:

Weeding blade, Blade cover assembly, Cap, Hex wrench

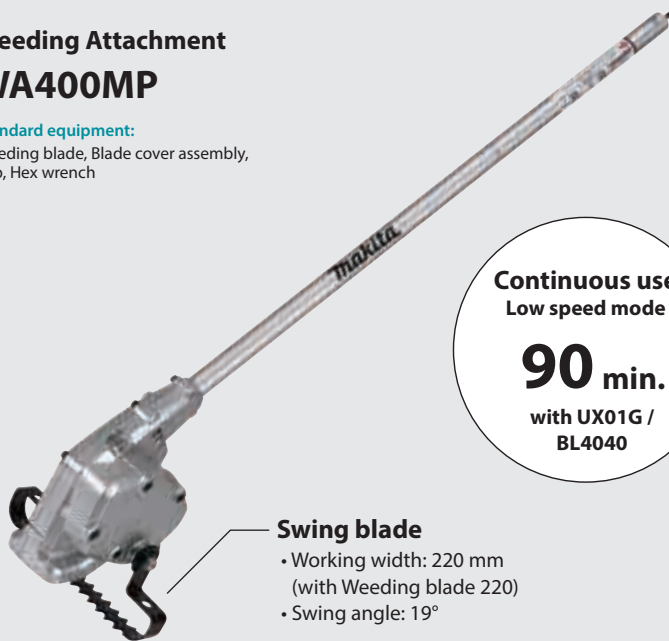

Continuous use
Low speed mode

90 min.

with UX01G / BL4040

Swing blade

- Working width: 220 mm (with Weeding blade 220)
- Swing angle: 19°

Compatible models

Cordless Multi Function Power Head

UX01G

40V max



DUX60

18V x2



DUX18

18V



Multi function power head	Continuous Use (min.)			
	Battery	High	Med	Low
UX01G	BL4040	45	75	90
DUX60	BL1860B x2	90	105	150
DUX18	BL1860B	75	-	90

Multi function power head	Strokes per minute (min ⁻¹)			Working width	Swing angle	Vibration Front handle (m/s ²)	Vibration Rear handle (m/s ²)	Sound power level LWA (dB(A))	Sound pressure level LPA (dB(A))	Dimensions (L x W x H)	Net weight
	High	Med	Low								
UX01G	970	815	570	220 mm	19°	2.8	2.5	89	77	1,900 x 236 x 256 mm (74-3/4 x 9-1/4 x 10-1/8")	7.3 kg (16.1 lbs.)
DUX60	970	815	570			3.0	2.7	88	74	1,910 x 236 x 256 mm (75-1/4 x 9-1/4 x 10-1/8")	7.4 kg (16.3 lbs.)
DUX18	970	-	680			2.8	2.5	88	73	1,881 x 236 x 256 mm (74 x 9-1/4 x 10-1/8")	6.0 kg (13.2 lbs.)
Attachment only										980 x 226 x 196 mm (38-1/2 x 8-7/8 x 7-3/4")	2.8 kg (6.2 lbs.)

Weight according to EPTA Procedure 01/2014

Items of standard equipment and specifications may vary by country or area.

Makita Corporation

3-11-8 Sumiyoshi-cho, Anjo, Aichi, 446-8502 Japan



PRINTED IN JAPAN 202405

www.makita.com